esave Billing System	2
Transformation of technology	2
Why is there a new billing system?	2
New from Q3 / 24	2
esave Billing System up to 3rd Quarter	3
Opening a new facility	4
Extending the Gateway function	5
esave Billing System from 3rd Quarter	6
Subscription options	6
Option 1: Cellular und Mesh Geräte gemischt	7
Option 2: Cellular-only system	8
Manual mode	9
Automatischer Modus	10
Adding credits	11
esave Installation with QR-Code	12

Transformation of technology

The latest developments and technologies are constantly opening up new possibilities. Gateways that have to be additionally installed in a control cabinet are being replaced by 2-in-1 controllers. Saves time during installation and creates new possibilities.

Gateway - Generation 1

Cellular Devices - Generation 2



Why is there a new billing system?

- ▶ Transformation of technology results in many more opportunities and security.
- ▶ Standardization of the billing system. No distinction is made between Gateway Generation 1 and Generation 2.

New from Q3 / 24

- ▶ Monthly or yearly billing possible.
- ▶ Prepayment so that no monthly or yearly costs are incurred.
- ▶ Two subscription options: Standard or Light.
- ▶ Mixing system with Gen. 1 and 2 devices can only include one subscription.
- ▶ Systems with Gateway Gen. 2 devices can include both subscriptions.
- ▶ Distribution across several servers to make the entire system more efficient and stable.

Opening a new facility

1. On the esave website under the following link, fill out the form for the “New system”.
[Fill in here](#)

Kundenadresse

<input type="text"/>	<input type="text"/>
<input type="text"/>	<input type="text"/>
<input type="text"/>	<input type="text"/>
<input type="text"/>	
<input type="checkbox"/> Rechnungsadresse gleich wie Kundenadresse	
<input type="text"/>	
<input type="text"/>	
<input type="checkbox"/> Gateway Funktion	
<input type="text"/>	

Terms of payment: 15 days net

2. After processing the form, the customer address will receive the access data by e-mail. The customer is then authorized to create new users.
3. The billing address will receive the invoice by e-mail. If this is not paid within 15 days, the system will be set to Inactive.

Terms of payment: Prepayment

2. The billing address will receive the invoice by e-mail. This must be paid first. Once the invoice has been paid, the new system is created.
3. After payment, the customer address receives the access data by e-mail. He is then authorized to create new users.

Extending the Gateway function

1. On the esave website, fill out the form for the “Gateway function acquired”.
[Fill in here](#)

Kundenadresse

Firma*

Kontaktperson*

Persönliche E-Mail*

Telefon*

Rechnungsadresse gleich wie Kundenadresse

Referenz Nummer

Anlagenname

Anlagennummer

Serien Nr. und jeweilig wie viele Geräte freigeschaltet werden sollen

Terms of payment: 15 days net

2. After receipt of the order, it will be processed within 24 hours. The customer will be informed as soon as the gateway function has been activated.
3. The stored billing address will receive the invoice by e-mail. If this is not paid within 15 days, the gateway function will be deactivated.

Terms of payment: Prepayment

2. The billing address will receive the invoice by e-mail. This must be paid first. Once the invoice has been paid, the gateway function is activated.
3. As soon as the gateway function has been activated for the desired system, the customer will be informed.

Where can I find the attachment no.

1. Log in to the SL-Control web platform.
[Login](#)
2. Open your or the desired system.
3. The system no. must be omitted from the URL.

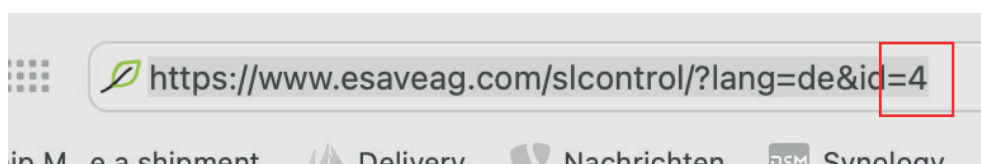

Subscription options

Features	Standard	Light
Data transmission	every 15 minutes	When switching on and from 00:00 every 8 hours. When switching on at 00:00 at 08:00 at 16:00
Credits per year per controlled light point	12 Credits	6 Credits
Highest data Information	✓	✗
Offline storage of data in the controller (min. 24 hours)	✓	✗
Real-time Energy data	✓	✗
Real-time Traffic data	✓	✗
Real-time Weather data	✓	✗
Costs per year and controlled light point (new also for SL-Gateway)	12 Credits per Light point	6 Credits per Light point

 Attention: Abo mixing systems are only possible in manual mode. This is not possible in automatic mode

Cellular Controller

- ▶ SLC-Hub203-C
- ▶ SLC-Motion203-C ST / HS
- ▶ SLC-Enviro203-C
- ▶ SLC-RC Switch203-C

Cellular devices have 5 years of connectivity included, which are credited directly to the system. The devices should be put into operation no later than 2 years after delivery (from esave ag warehouse). From the 3rd year, 4 years of connectivity are still guaranteed, from the 4th year 3 years, etc.

Option 1: Cellular und Mesh Geräte gemischt

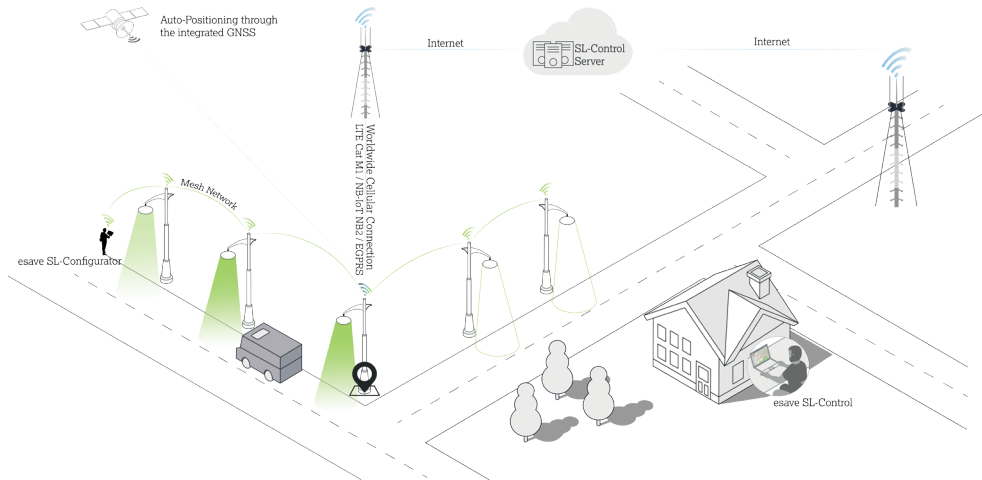

	Standard	Light
Number of Controllers with Cellular	1 pce.	1 pce.
Number of Controllers without Cellular	up to 100 units per cellular controller	up to 100 units per cellular controller
Cellular Controller	5 years connectivity incl.	5 years connectivity incl.
Each additional device	12 Credits per Year	6 Credits per Year
Cellular Controller	Cellular devices must be put in operation no later than 2 years after delivery. From the 3rd year, 1 year will be year is deducted.	Cellular devices must be put in operation no later than 2 years after delivery. From the 3rd year, 1 year will be year is deducted.

! Attention: Commissioning via QR code is mandatory. Otherwise, these devices will not be displayed on the web platform.

Option 2: Cellular-only system

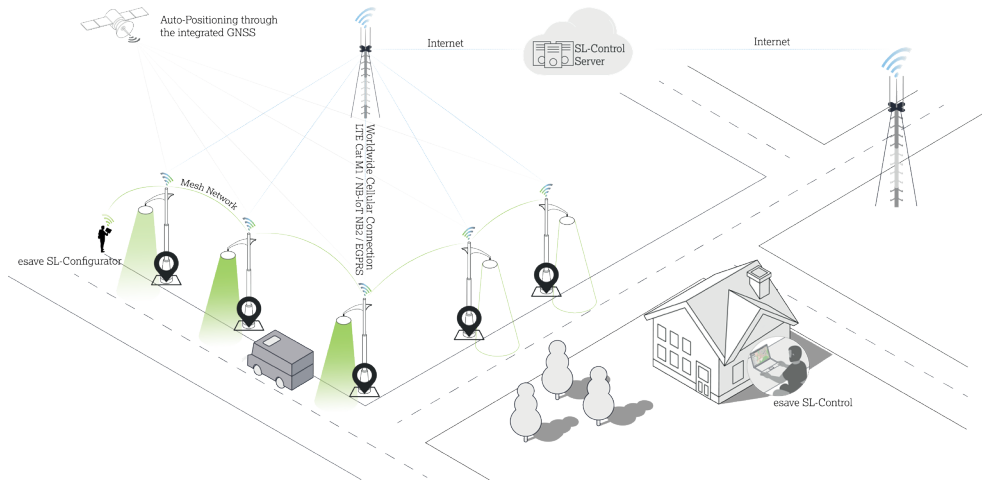

	Standard	Light
Number of Controllers with Cellular	X pce.	X pce.
Number of Controllers without Cellular	0 pce.	0 pce.
Cellular Controller	5 years connectivity incl.	5 years connectivity incl.
Each additional device	12 Credits per Year	6 Credits per Year
Cellular Controller	Cellular devices must be put in operation no later than 2 years after delivery. From the 3rd year, 1 year will be year is deducted.	Cellular devices must be put in operation no later than 2 years after delivery. From the 3rd year, 1 year will be year is deducted.

! Attention: Installation via QR code is mandatory. Otherwise, these devices will not be displayed on the web platform.

Manual mode

! Attention: If a 1st generation SL-Gateway is in the system, this mode cannot be activated.

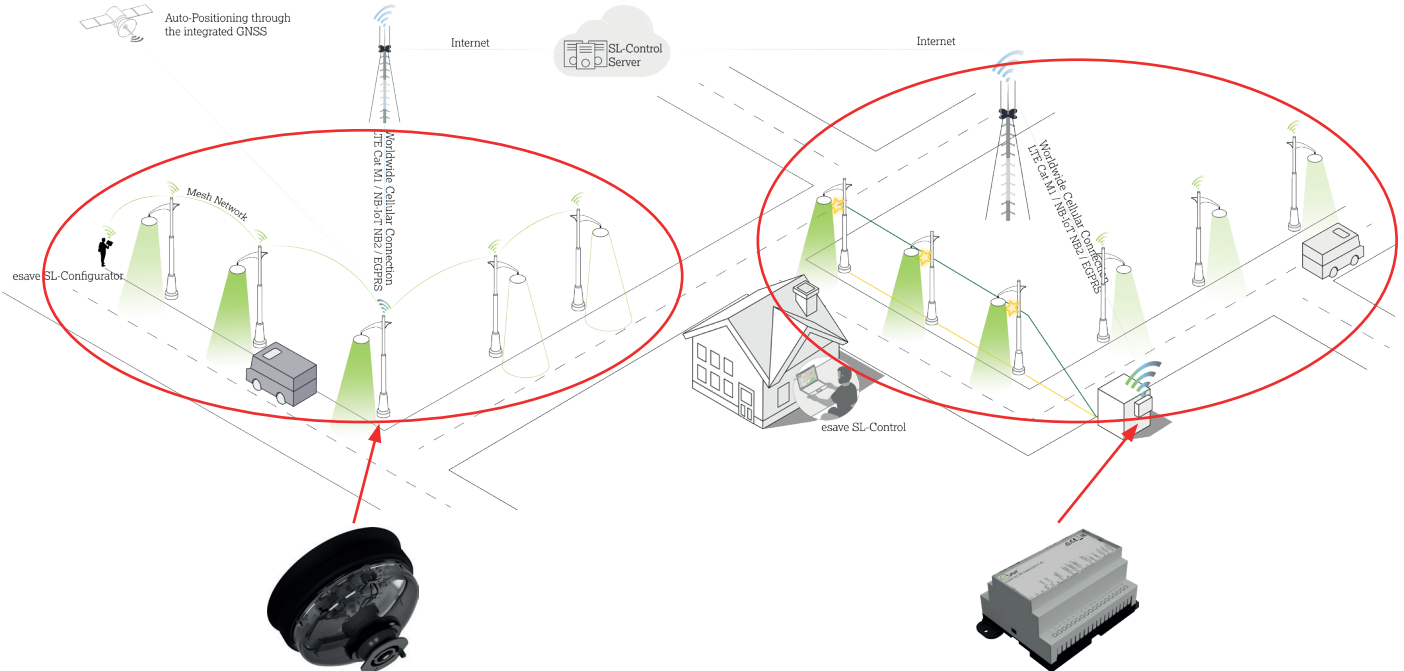

	Standard Abo
No. of managed devices	4 pce. (max. 100 pce.)
Transmission	Every 15 min
Black and white list of devices to be used	✓
Highest level of data information	✓
Offline data storage	✓
Real-time energy data	✓
Real-time traffic data	✓
Real-time weather data	✓
Credits per Year	4x 12 Credits Total 48 Credits

	Light Abo
No. of managed devices	3 pce. (max. 100 pce.)
Transmission	Beim Einschalten und ab 00:00 Uhr alle 8 Std.
Black and white list of devices to be used	✓
Highest level of data information	✗
Offline data storage	✗
Real-time energy data	✗
Real-time traffic data	✗
Real-time weather data	✗
Credits per Year	3x 6 Credits Total 18 Credits

Automatischer Modus

! Automatic with SL-Gateway Generation 1

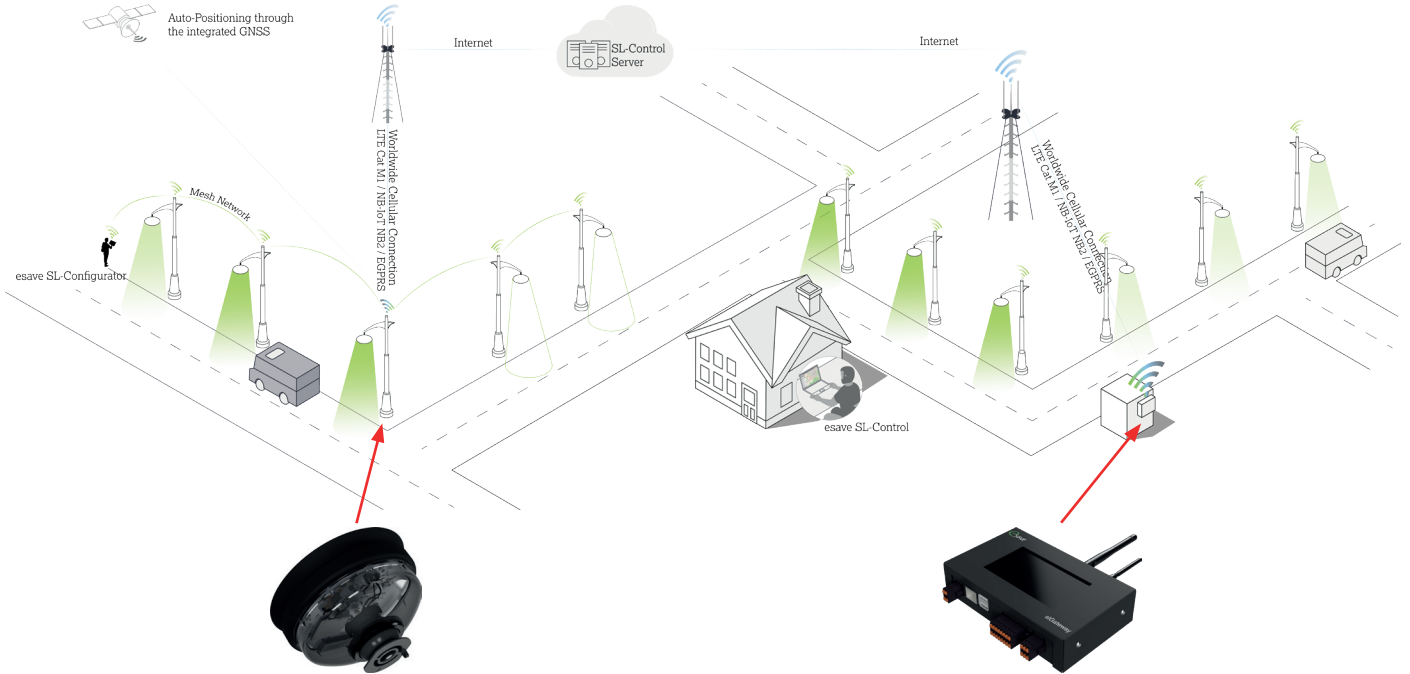

You can only choose between the Light or Standard subscription. It is not possible to mix the two subscriptions.

Adding credits

1. Fill out the “Add credits” form on the esave website under the following link.
[Fill in here](#)

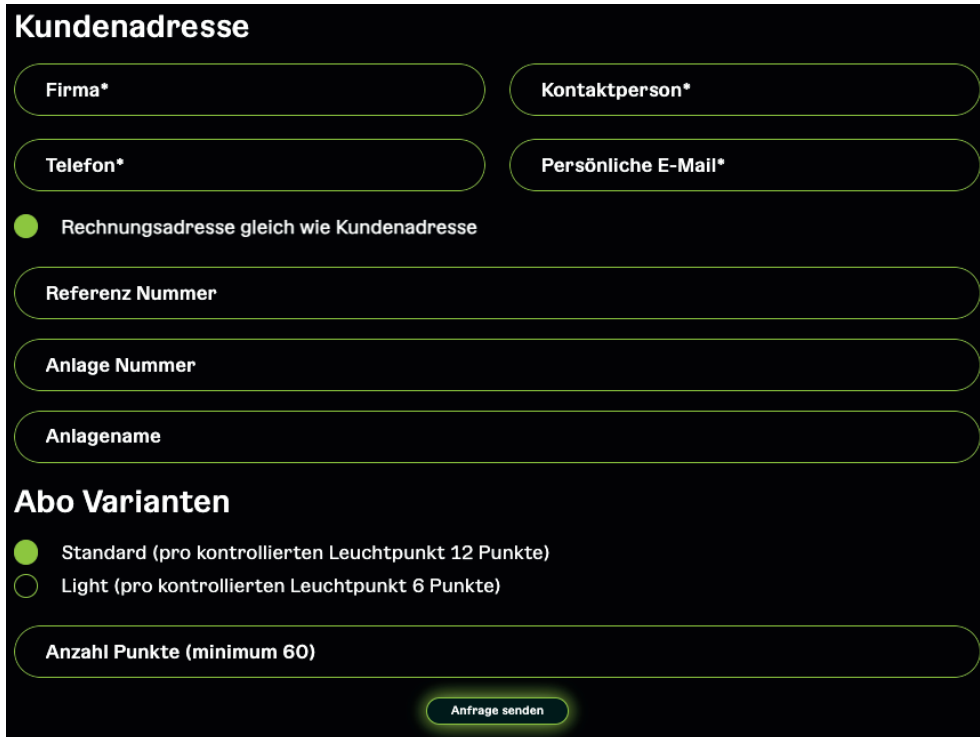

Terms of payment: 15 days net

2. After receipt of the order, it will be processed within 24 hours. The customer will be informed as soon as the credits have been credited to the system.
3. The billing address on file will receive the invoice by e-mail. If this is not paid within 15 days, the credits will be deducted.

Terms of payment: Prepayment

2. The billing address will receive the invoice by e-mail. This must be paid first. Once the invoice has been paid, the credits will be credited.
3. As soon as the credits have been credited to the desired system, the customer will be informed.

Where can I find the attachment no.

1. Log in to the SL-Control web platform.
[Login](#)
2. Open your or the desired system
3. The system no. is shown in the URL

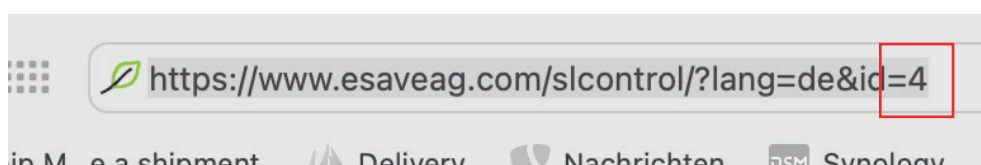



1. QR-Code labels

SLC controllers are always supplied with at least 3 QR code labels:

- ▶ The first label is already on the device.
- ▶ We recommend to attach the second label, directly on the light.
- ▶ The third label can, for example, be attached to the service door of the mast be attached.

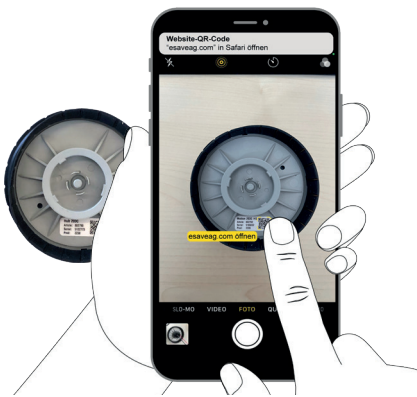

2. Scan the QR-Code

Use the camera app or QR code scanner app to open the corresponding link.

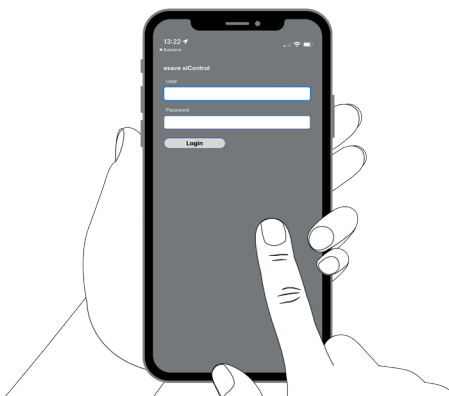

3. Log in to the SL-Control

To start installation, you must log in with the esave SL-Control login.

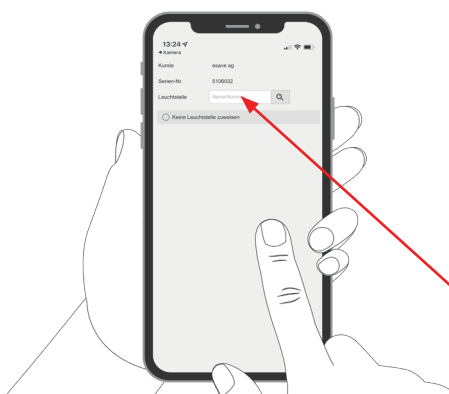

4. Assign light point

As usual, a controller can be assigned to the light point. With cellular controllers, it is possible to skip this point.

Enter light point no.

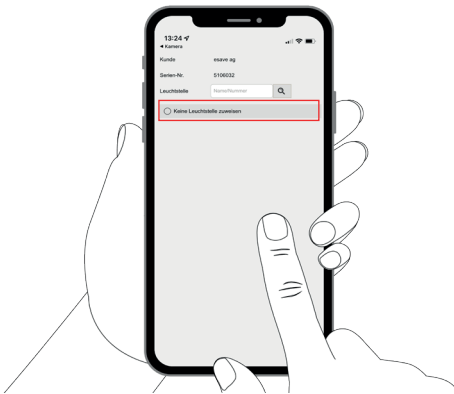

5. Do not assign a light point

If the item “Do not assign a light point” is selected, item 4 can be skipped.

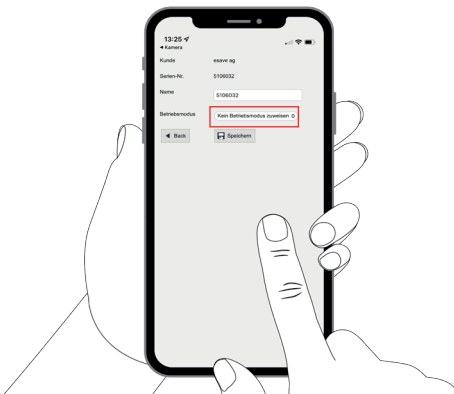

6. Optional: Assign operating mode

Operating modes that were created in the SL-Control web platform can be assigned directly to the streetlight controller here.

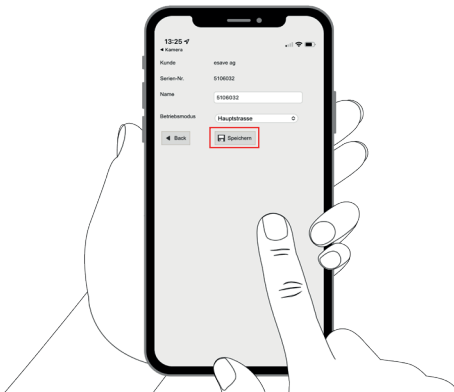

7. Save settings

Click “Save” to save all the settings and continue with the next light.